

Department of Engineering  
Tim Bryan, P.E., County Engineer

3137 South Liberty Street, Canton, MS 39046  
Office (601) 790-2525 FAX (601) 859-3430

**MEMORANDUM**

December 11, 2023

To: Sheila Jones, Supervisor, District I  
Trey Baxter, Supervisor, District II  
Gerald Steen, Supervisor, District III  
Karl Banks, Supervisor, District IV  
Paul Griffin, Supervisor, District V

From: Tim Bryan, P.E., PTOE  
County Engineer

Re: Comcast Cable Utility Permit  
County Road Name, Westlake Circle

The Engineering Department recommends approval of the permit application for Comcast Cable will start at existing pole then continue placing new peds for the Westlake Circle and the county road name listed below.

Saddle Brook Cove

Fairburn Court

Lois Court

Wrenwood Court

Ivywood Court

Revised: 2/14/2019



## PERMIT APPLICATION FOR THE CONSTRUCTION OR ADJUSTMENT OF A UTILITY WITHIN COUNTY ROAD RIGHT-OF-WAY

Utility Information: Utility Name: COMCAST

Address: 120 SILVERLEAF DR City/State/Zip: MADISON MS 39110

Contact Person: KENNETH GOSS Contact's Phone: 601-862-4834

Project Information: County Road Name: WESTLAKE CIR

(If located within more than one road right-of-way, use Appendix 1 for additional descriptions)

Beginning Location: 32.529115-90.157643 Ending Location: 32.532198-90.167616

Length of Project: 6371' Section: 23 Township: 8N Range: 1E

Description of Work: \_\_\_\_\_

COMCAST WILL START AT EXSITING POLE THEN CONTINUE PLACING NEW PEDS FOR THE WESTLAKE CIRCLE.

PLEASE SEE ATTACHED PRINTS FOR EXACT LOCATIONS.

Check Box if Appendix 1 is to be included as a part of this Application

Whereas the above stated Utility makes application to the **Madison County Board of Supervisors** for a Construction Permit. Attached hereto are drawings and plans for the construction of the above facilities located within Madison County owned public rights-of-way. Once stamped by the Madison County Engineering Department, these plans shall not be changed or altered without written approval of the County Engineer, or his representative. A copy of the approved permit and plans shall be on-site at all times during construction.

The Applicant Utility shall comply with all policies, procedures and construction practices as outlined in *A Policy for The Accommodation of Utility Facilities within the Right-of-Way of all Public County Roads* (hereinafter referred to as the "Policy"), as adopted on November 1, 2005, by the **Madison County Board of Supervisors**, and which is hereby made a part of this Application Agreement.

If facilities are to be located within the Rights-of-Way of the County-Federal or State Aid System, Applicant Utility also agrees to comply with applicable provisions of *S.O.P. No. SA II-2-8, Accommodation of Utilities on Rights-of-Way*, issued by the State Aid Engineer and dated July 1, 2005.

The Applicant Utility understands and agrees that, except as herein granted, no right, title, claim, or easement to said road right-of-way is granted by the issuance of this permit. If this Utility is listed in the general provisions of the Policy, it will be adjusted to comply with same without cost to the County, unless the variance from the Policy has been approved by the granting of the Permit pursuant to this Application.

The Applicant Utility further understands that the Utility's engineering, plant, or other personnel will be responsible for the staking and construction supervision of the work set out above and as shown on the attached plans. If work impacts traffic in any way, the appropriate traffic control shall be installed per the *Manual of Uniform Traffic Control Devices*, Latest Edition.

The Applicant Utility understands that the County Engineer, or his representative, may issue a Stop Work Order at any time if it is deemed that site conditions are not suitable for construction or if any of the requirements of this permit are not being met.

Many County Roads have variable Rights-of-Way and/or no Right-of-Way at all and are maintained under a Prescriptive Easement. It is the sole responsibility of the Applicant Utility to verify the existence and limits of public rights-of-way. If none exists, it is the

responsibility of the Applicant Utility to acquire an easement for their Facilities from the applicable property owner(s). Madison County in no way verifies the limits of Right-of-Way as shown on the permit application.

The Applicant Utility shall be responsible for all future maintenance and repair of the facilities installed under this permit. The Applicant Utility shall make future adjustments to, or relocate, the facilities located within road or highway right-of-way when required for road or highway widening or other road or highway construction at no cost to Madison County. The Applicant Utility shall relocate said utilities within sixty (60) days of notification by County by registered mail, return receipt requested, unless otherwise designated by the County Engineer. Further, any maintenance, repair, or construction shall be done in such a manner as to occasion no unreasonable interference with the normal flow and safety to traffic and at the expense of the utility company. When reasonable care has been taken to locate said utility facilities within the right-of-way, the Applicant Utility understands that any damages caused by routine maintenance and construction by County forces shall be borne by the Applicant Utility.

The Applicant Utility further agrees to indemnify and hold Madison County harmless for any and all claims, accidents, damages, liabilities and expenses occasioned wholly, or in part, by any act or omission of applicant, its agents or employees. In case County shall, without fault on its own part, be made a party to any litigation commenced by or against applicant, then applicant shall protect and hold County harmless, and shall pay all costs, expenses and reasonable attorney's fees incurred or paid by County in connection with said litigation.

All underground facilities shall be installed at a depth equal to or greater than 48" below the lowest adjacent grade.

All pipes carrying liquid shall be encased under County maintained roads.

WITNESS the signature of the Applicant this the 10TH day of DECEMBER, 2023.

By: Kenneth Goss  
(Applicant Signature)

Title: COMCAST COORDINATOR

**Note:** Applicant must be an employee of the Utility named in this application. The Madison County Board of Supervisors will not recognize a Contractor, Subcontractor, Agent, or Consulting Engineer as the Applicant. Utility Company shall be fully responsible for all work performed under this application.

I, or my authorized representative, have reviewed this application and determined that the drawing, sketches, and plans submitted by the Applicant meet the requirements of A Policy for The Accommodation of Utility Facilities within the Right-of-Way of all Public County Roads.

**APPROVED**  
By **timothy.bryan at 12:27 pm, Dec 12, 2023**  
Tim Bryan, P.E.  
County Engineer

AGREED TO AND APPROVED BY:

\_\_\_\_\_  
Madison County Board President

Date: \_\_\_\_\_

ENTERED INTO THE MINUTES OF THE BOARD OF SUPERVISORS OF MADISON COUNTY, MISSISSIPPI ON THIS \_\_\_\_\_ DAY OF \_\_\_\_\_, 20\_\_\_\_\_.

## Appendix 1

County Road Name: SADDLE BROOK CV  
Beginning Location: 32.526390-90.157642 Ending Location: 32.527704-90.170918  
Length of Project: 6514' Section: 23 Township: 8N Range: 1E  
Description of Work: \_\_\_\_\_  
COMCAST WILL START AT EXSITING POLE THEN CONTINUE PLACING NEW PEDS FOR THE SADDLE BROOK CV

County Road Name: FAIRBURN CT  
Beginning Location: 32.527523-90.170606 Ending Location: 32.527704-90.170918  
Length of Project: 1357' Section: 23 Township: 8N Range: 1E  
Description of Work: COMCAST WILL CONTINUE TO PLACE NEW PEDS.

County Road Name: LOIS CT  
Beginning Location: 32.525707-90.158693 Ending Location: 32.525805-90.159084  
Length of Project: 1031' Section: 23 Township: 8N Range: 1E  
Description of Work: COMCAST WILL CONTINUE TO PLACE NEW PEDS.

County Road Name: WRENWOOD CT  
Beginning Location: 32.525058-90.160069 Ending Location: 32.524749-90.160173  
Length of Project: 228' Section: 23 Township: 8N Range: 1E  
Description of Work: COMCAST WILL CONTINUE TO PLACE NEW PEDS.

County Road Name: IVYWOOD CT  
Beginning Location: 32.525784-90.168226 Ending Location: 32.525892-90.168374  
Length of Project: 1114' Section: 23 Township: 8N Range: 1E  
Description of Work: COMCAST WILL CONTINUE TO PLACE NEW PEDS.









ENGINEERED BY:  
PERMITS@NWAUTILITIES.COM



ENGINEERED FOR:



DISCLAIMER

THESE DRAWINGS AND SPECIFICATIONS BEING ISSUED IN STRICT CONFIDENCE AND SHALL NOT BE REPRODUCED, COPIED, OR USED FOR ANY PURPOSE WITHOUT SPECIFIC WRITTEN PERMISSION

PROJECT TOTAL FOOTAGES

NEW AERIAL BUILD 0'  
NEW OVERLASH 0'  
NEW BURIED 15790'



MATERIAL LIST

DESCRIPTION	QUANTITY

PROJECT IDENTIFICATION

JB #: JB0001659213  
ADDRESS: 120 SILVERLEAF DR  
CITY, STATE, ZIP: MADISON, MS, 39110  
COUNTY: MADISON  
COORDINATOR: KENNETH GOSS  
DATE: 12-07-23  
REVISION: 0

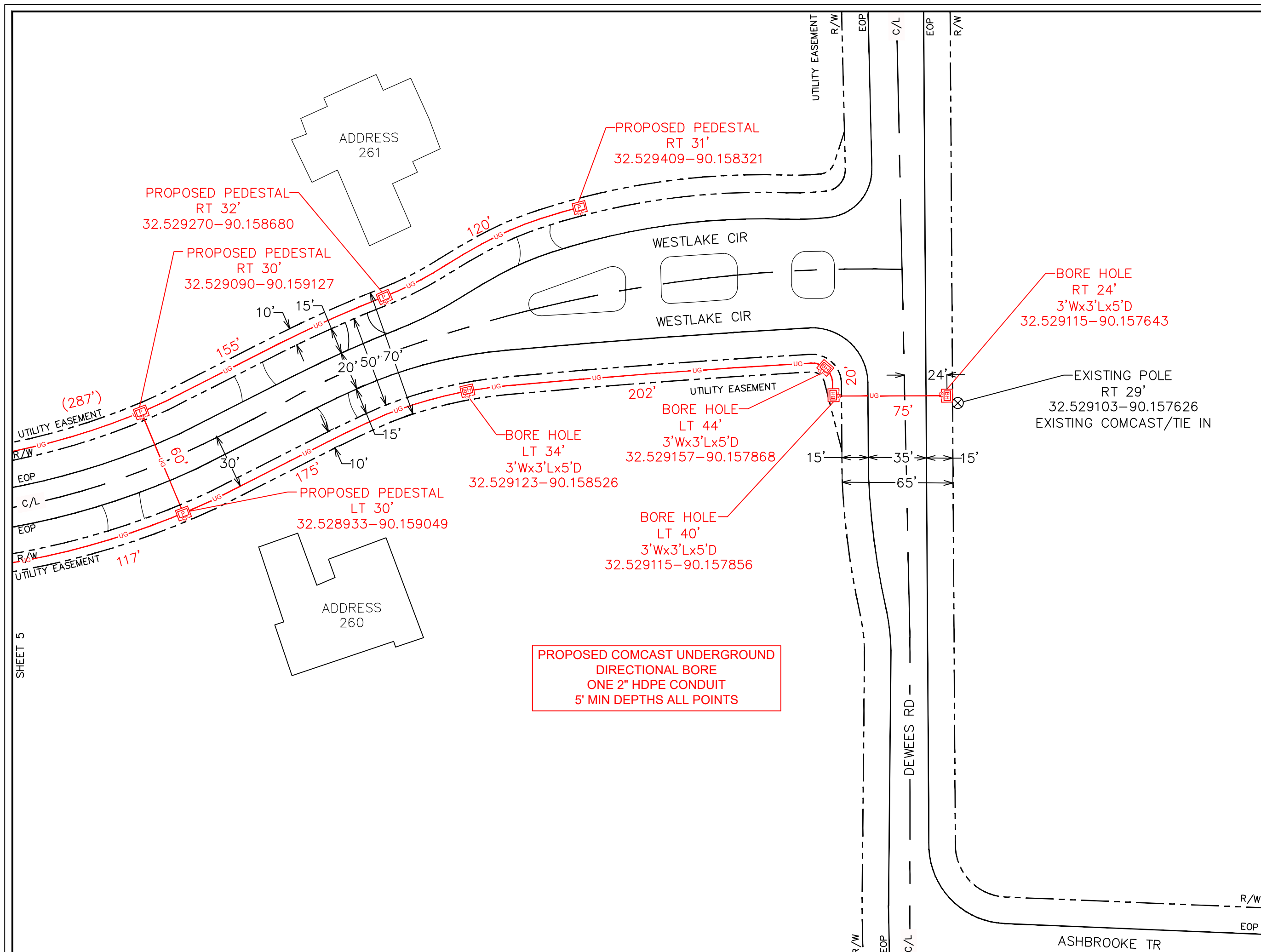





ENGINEERED FOR:



DISCLAIMER

THESE DRAWINGS AND SPECIFICATIONS  
BEING ISSUED IN STRICT  
CONFIDENCE AND SHALL NOT BE  
REPRODUCED,  
COPIED, OR USED FOR ANY PURPOSE  
WITHOUT SPECIFIC WRITTEN PERMISSION

PROJECT TOTAL FOOTAGES

NEW AERIAL BUILD	0'
NEW OVERLASH	0'
NEW BURIED	15790'



MATERIAL LIST

DESCRIPTION	QUANTITY

PROJECT IDENTIFICATION

JB #: JB0001659213  
ADDRESS: 120 SILVERLEAF DR  
CITY, STATE, ZIP: MADISON, MS, 39110  
COUNTY: MADISON  
COORDINATOR: KENNETH GOSS  
DATE: 12-07-23  
REVISION: 0

PROPOSED COMCAST UNDERGROUND  
DIRECTIONAL BORE  
ONE 2" HDPE CONDUIT  
5' MIN DEPTHS ALL POINTS

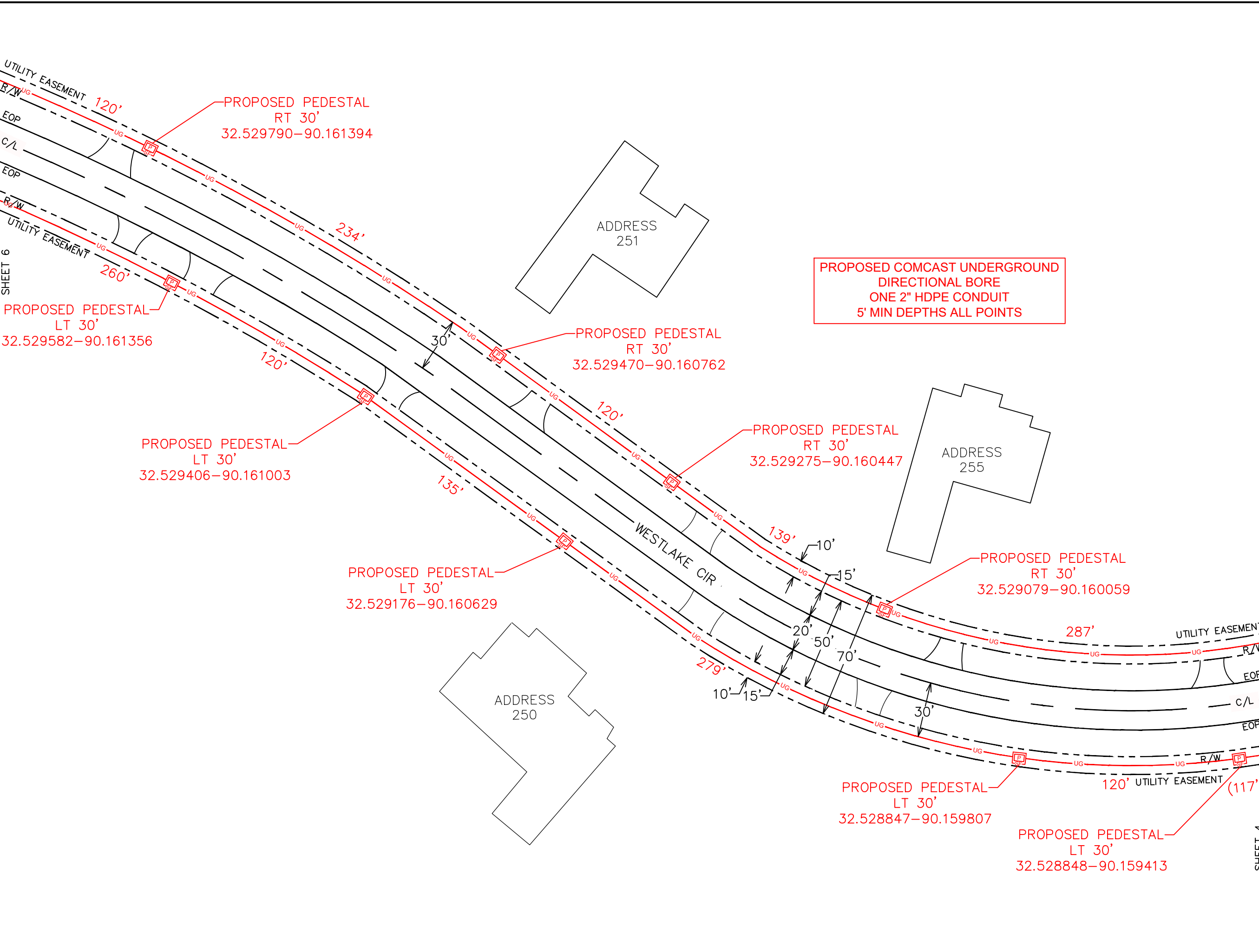

SHEET 6

SHEET 4

ENGINEERED BY:  
PERMITS@NWAUTILITIES.COM



ENGINEERED FOR:



DISCLAIMER

THESE DRAWINGS AND SPECIFICATIONS  
BEING ISSUED IN STRICT  
CONFIDENCE AND SHALL NOT BE  
REPRODUCED,  
COPIED, OR USED FOR ANY PURPOSE  
WITHOUT SPECIFIC WRITTEN PERMISSION

PROJECT TOTAL FOOTAGES

NEW AERIAL BUILD	0'
NEW OVERLASH	0'
NEW BURIED	15790'



MATERIAL LIST

DESCRIPTION	QUANTITY

PROJECT IDENTIFICATION

JB #: JB0001659213  
 ADDRESS: 120 SILVERLEAF DR  
 CITY, STATE, ZIP: MADISON, MS, 39110  
 COUNTY: MADISON  
 COORDINATOR: KENNETH GOSS  
 DATE: 12-07-23  
 REVISION: 0

SHEET 5

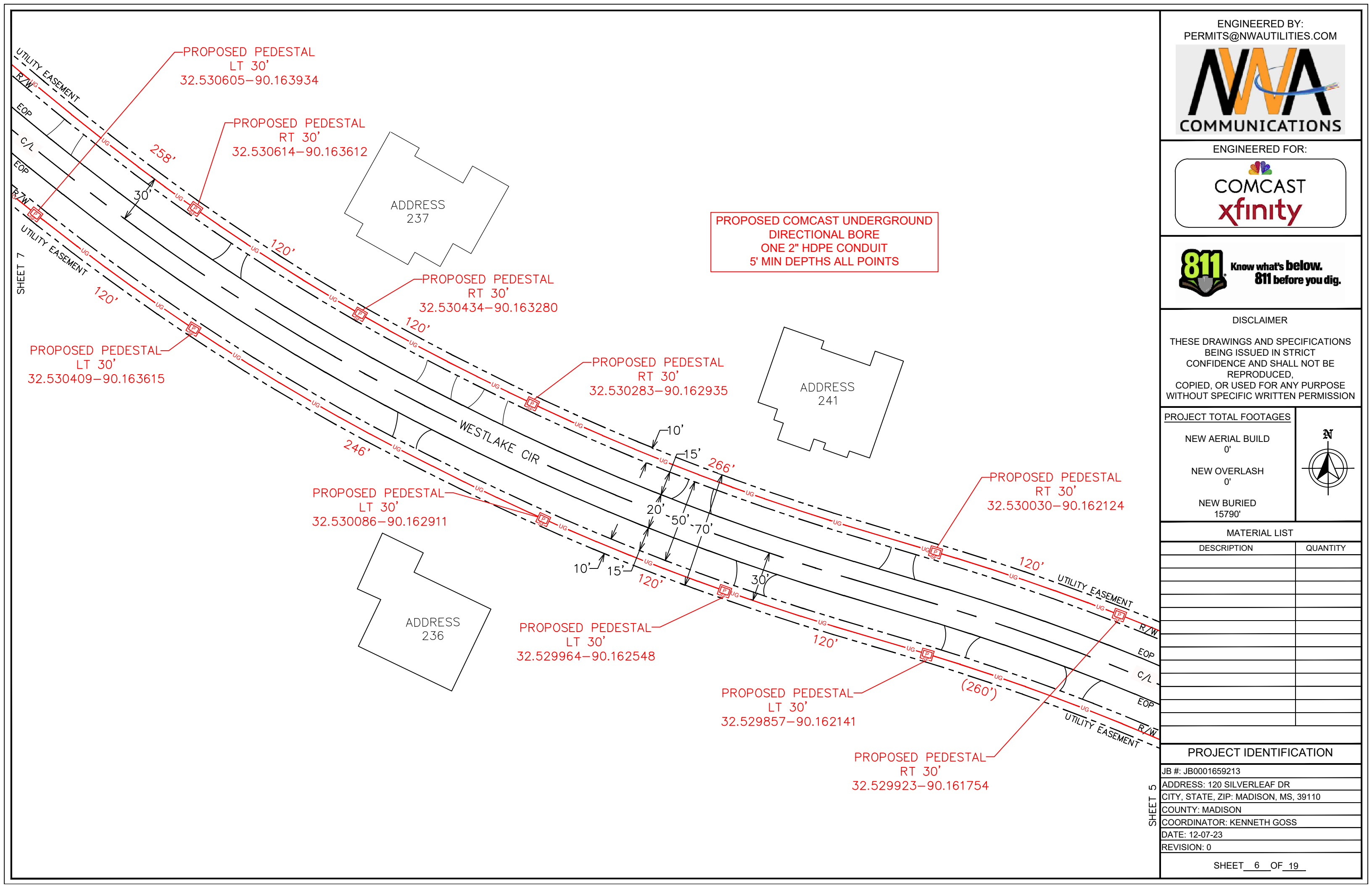

SHEET 7



ENGINEERED FOR:

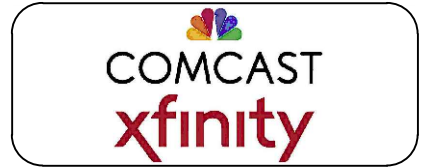

DISCLAIMER

THESE DRAWINGS AND SPECIFICATIONS  
BEING ISSUED IN STRICT  
CONFIDENCE AND SHALL NOT BE  
REPRODUCED,  
COPIED, OR USED FOR ANY PURPOSE  
WITHOUT SPECIFIC WRITTEN PERMISSION

PROJECT TOTAL FOOTAGES

NEW AERIAL BUILD	0'
NEW OVERLASH	0'
NEW BURIED	15790'



MATERIAL LIST

DESCRIPTION	QUANTITY

PROJECT IDENTIFICATION

JB #: JB0001659213
ADDRESS: 120 SILVERLEAF DR
CITY, STATE, ZIP: MADISON, MS, 39110
COUNTY: MADISON
COORDINATOR: KENNETH GOSS
DATE: 12-07-23
REVISION: 0

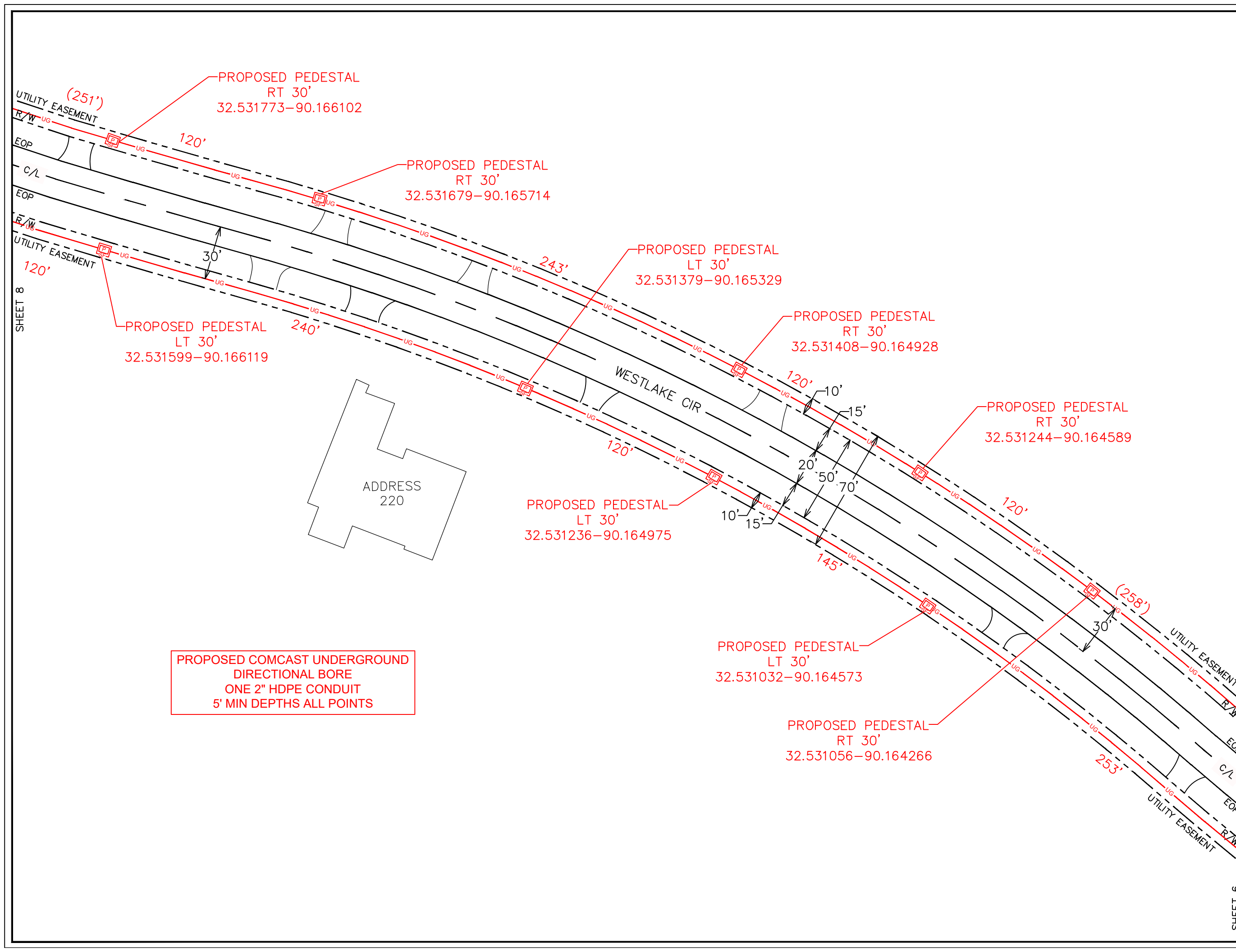

SHEET 8

SHEET 6



ENGINEERED FOR:



**DISCLAIMER**

THESE DRAWINGS AND SPECIFICATIONS  
BEING ISSUED IN STRICT  
CONFIDENCE AND SHALL NOT BE  
REPRODUCED,  
COPIED, OR USED FOR ANY PURPOSE  
WITHOUT SPECIFIC WRITTEN PERMISSION

**PROJECT TOTAL FOOTAGES**

NEW AERIAL BUILD	0'
NEW OVERLASH	0'
NEW BURIED	15790'



**MATERIAL LIST**

DESCRIPTION	QUANTITY

**PROJECT IDENTIFICATION**

JB #: JB0001659213
ADDRESS: 120 SILVERLEAF DR
CITY, STATE, ZIP: MADISON, MS, 39110
COUNTY: MADISON
COORDINATOR: KENNETH GOSS
DATE: 12-07-23
REVISION: 0

SHEET 7

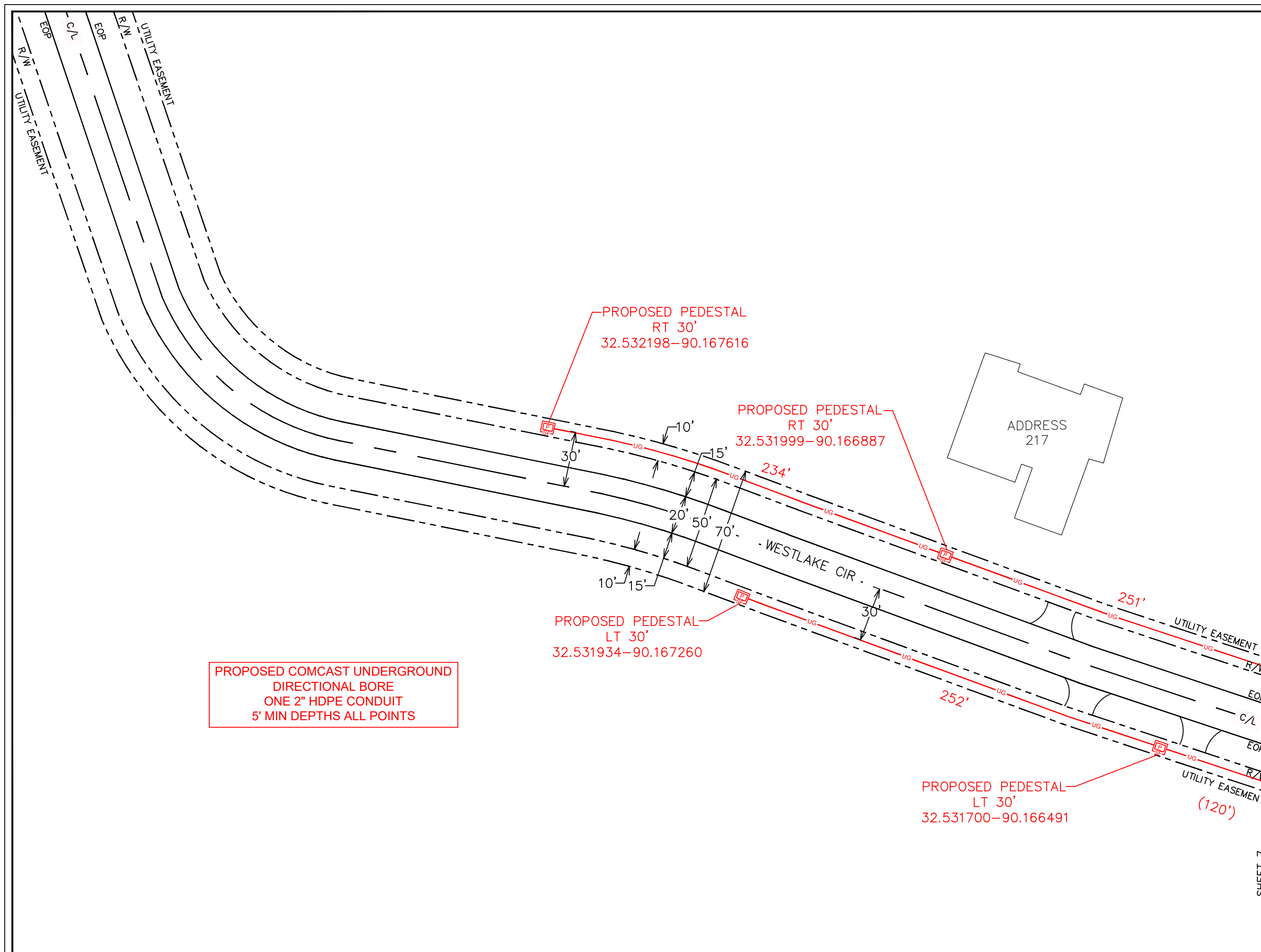

**PROPOSED COMCAST UNDERGROUND  
DIRECTIONAL BORE  
ONE 2" HDPE CONDUIT  
5' MIN DEPTHS ALL POINTS**



PROPOSED COMCAST UNDERGROUND DIRECTIONAL BORE ONE 2" HDPE CONDUIT 5' MIN DEPTHS ALL POINTS

PROPOSED PEDESTAL RT 30'  
32.526539-90.158549

BORE HOLE RT 31'  
3'Wx3'Lx5'D  
32.526685-90.157643

BORE HOLE RT 31'  
3'Wx3'Lx5'D  
32.526390-90.157642

PROPOSED PEDESTAL RT 30'  
32.526113-90.159079

PROPOSED PEDESTAL LT 30'  
32.525707-90.158693

PROPOSED PEDESTAL RT 30'  
32.525520-90.158808

PROPOSED PEDESTAL LT 30'  
32.525576-90.158615

PROPOSED PEDESTAL RT 30'  
32.525584-90.159573

BORE HOLE LT 30'  
3'Wx3'Lx5'D  
32.525392-90.159537

ENGINEERED BY:  
PERMITS@NWAUTILITIES.COM



ENGINEERED FOR:



DISCLAIMER

THESE DRAWINGS AND SPECIFICATIONS BEING ISSUED IN STRICT CONFIDENCE AND SHALL NOT BE REPRODUCED, COPIED, OR USED FOR ANY PURPOSE WITHOUT SPECIFIC WRITTEN PERMISSION

PROJECT TOTAL FOOTAGES

NEW AERIAL BUILD 0'  
NEW OVERLASH 0'  
NEW BURIED 15790'



MATERIAL LIST

DESCRIPTION	QUANTITY

PROJECT IDENTIFICATION

JB #: JB0001659213  
ADDRESS: 120 SILVERLEAF DR  
CITY, STATE, ZIP: MADISON, MS, 39110  
COUNTY: MADISON  
COORDINATOR: KENNETH GOSS  
DATE: 12-07-23  
REVISION: 0

SHEET 9 OF 19

SHEET 10

SHEET 11

SHEET 9

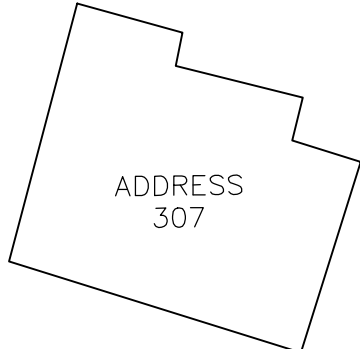
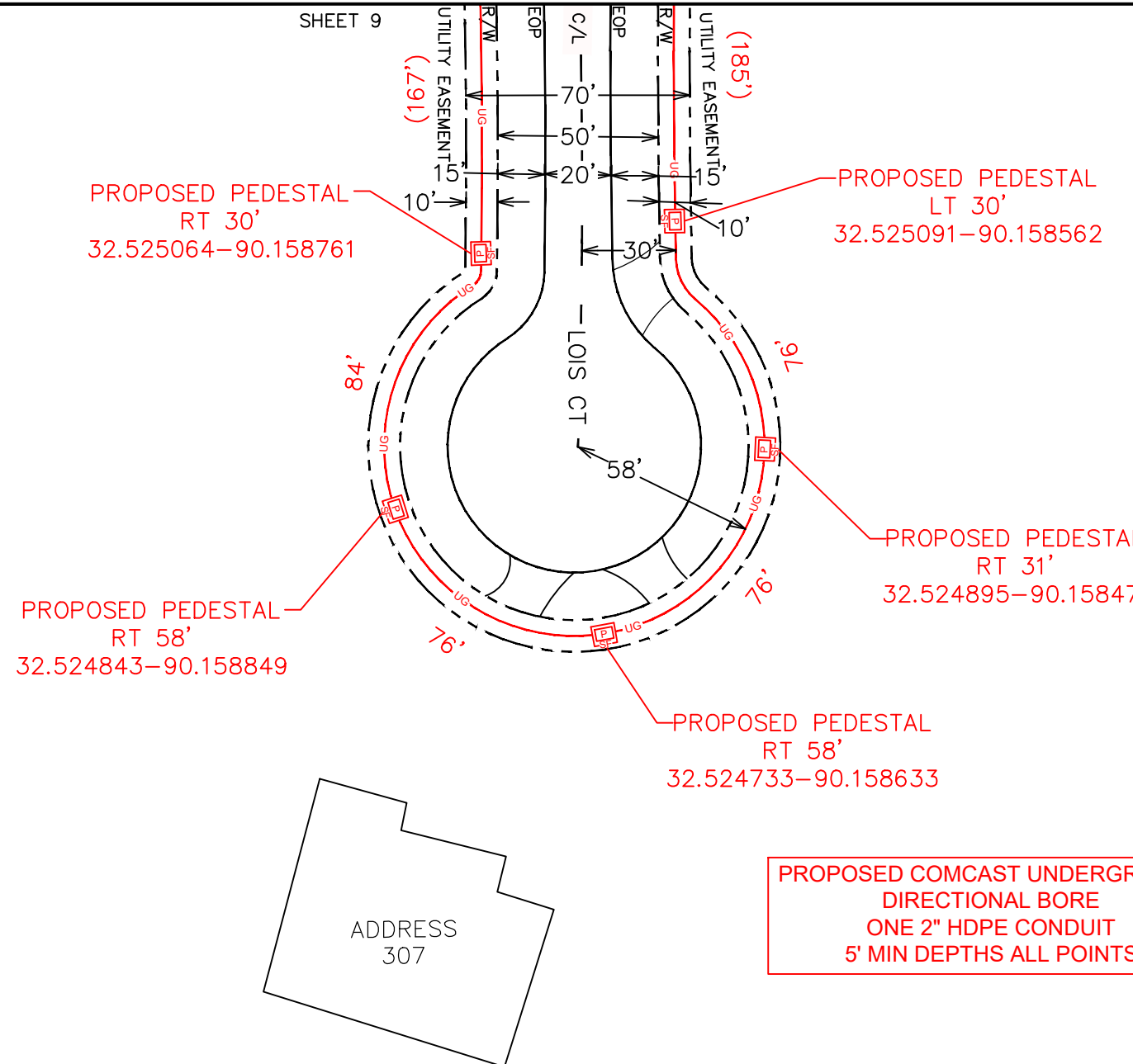

PROPOSED COMCAST UNDERGROUND  
 DIRECTIONAL BORE  
 ONE 2" HDPE CONDUIT  
 5' MIN DEPTHS ALL POINTS

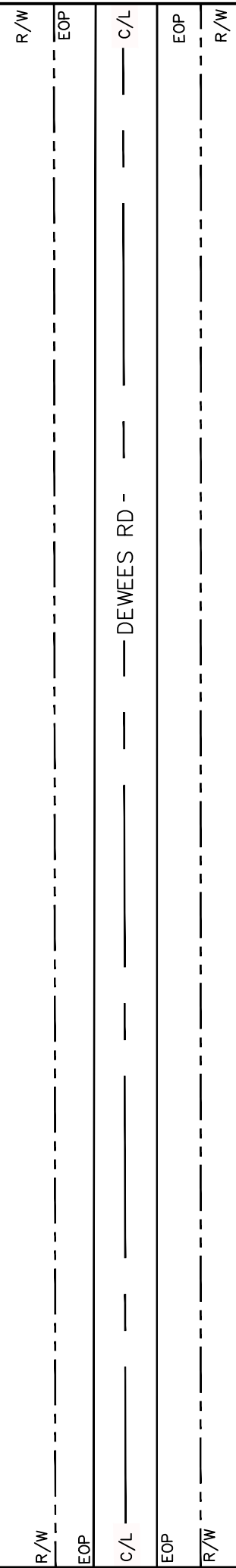

ENGINEERED BY:  
 PERMITS@NWAUTILITIES.COM

ENGINEERED FOR:

**DISCLAIMER**  
 THESE DRAWINGS AND SPECIFICATIONS BEING ISSUED IN STRICT CONFIDENCE AND SHALL NOT BE REPRODUCED, COPIED, OR USED FOR ANY PURPOSE WITHOUT SPECIFIC WRITTEN PERMISSION

PROJECT TOTAL FOOTAGES	
NEW AERIAL BUILD	0'
NEW OVERLASH	0'
NEW BURIED	15790'



MATERIAL LIST	
DESCRIPTION	QUANTITY

**PROJECT IDENTIFICATION**  
 JB #: JB0001659213  
 ADDRESS: 120 SILVERLEAF DR  
 CITY, STATE, ZIP: MADISON, MS, 39110  
 COUNTY: MADISON  
 COORDINATOR: KENNETH GOSS  
 DATE: 12-07-23  
 REVISION: 0



ENGINEERED BY:  
PERMITS@NWAUTILITIES.COM



ENGINEERED FOR:



DISCLAIMER

THESE DRAWINGS AND SPECIFICATIONS BEING ISSUED IN STRICT CONFIDENCE AND SHALL NOT BE REPRODUCED, COPIED, OR USED FOR ANY PURPOSE WITHOUT SPECIFIC WRITTEN PERMISSION

PROJECT TOTAL FOOTAGES

NEW AERIAL BUILD	0'
NEW OVERLASH	0'
NEW BURIED	15790'

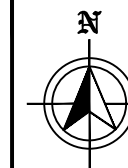

MATERIAL LIST

DESCRIPTION	QUANTITY

PROJECT IDENTIFICATION

JB #: JB0001659213
ADDRESS: 120 SILVERLEAF DR
CITY, STATE, ZIP: MADISON, MS, 39110
COUNTY: MADISON
COORDINATOR: KENNETH GOSS
DATE: 12-07-23
REVISION: 0

SHEET 9

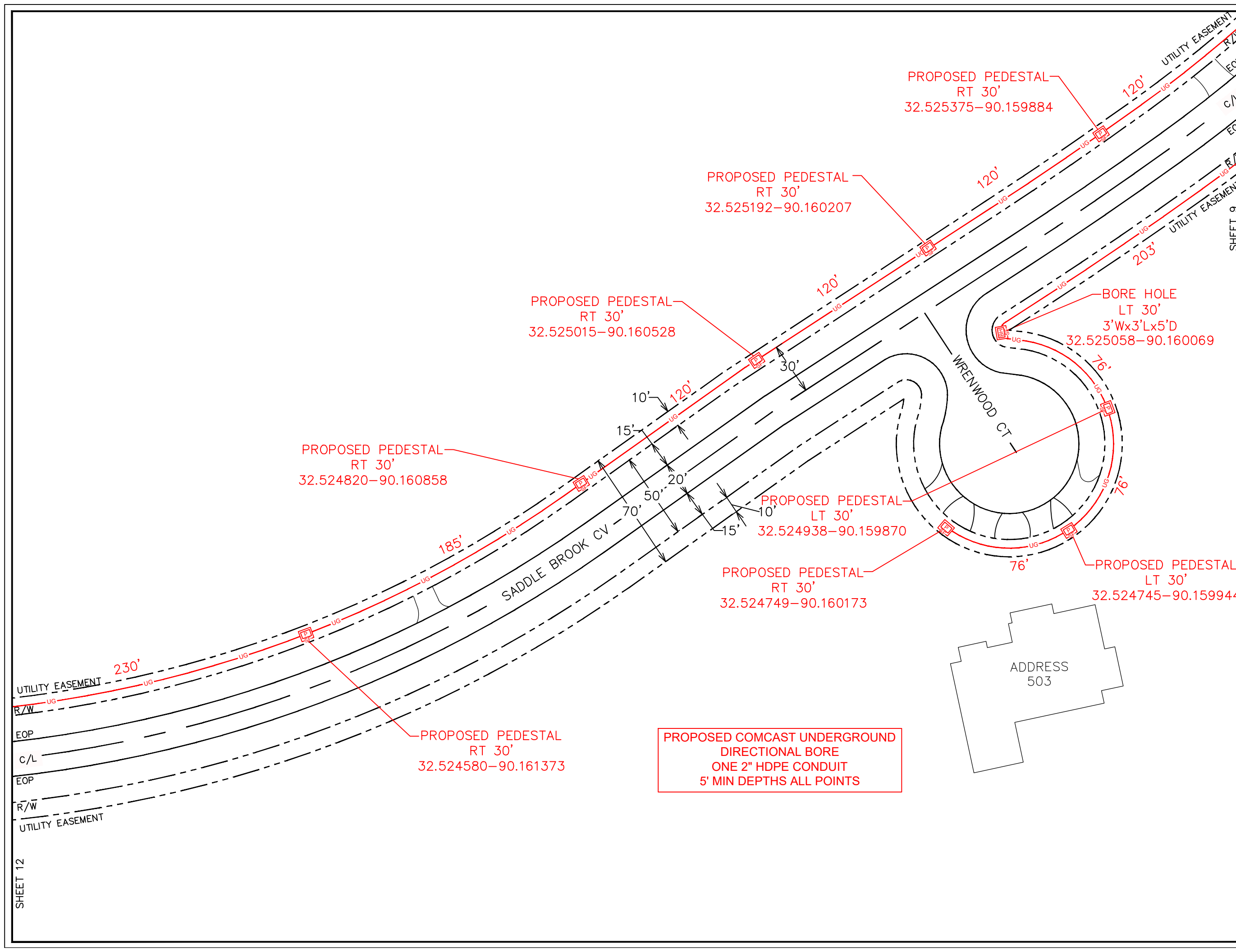

**PROPOSED COMCAST UNDERGROUND  
DIRECTIONAL BORE  
ONE 2" HDPE CONDUIT  
5' MIN DEPTHS ALL POINTS**



ENGINEERED FOR:



DISCLAIMER

THESE DRAWINGS AND SPECIFICATIONS BEING ISSUED IN STRICT CONFIDENCE AND SHALL NOT BE REPRODUCED, COPIED, OR USED FOR ANY PURPOSE WITHOUT SPECIFIC WRITTEN PERMISSION

PROJECT TOTAL FOOTAGES

NEW AERIAL BUILD	0'
NEW OVERLASH	0'
NEW BURIED	15790'



MATERIAL LIST

DESCRIPTION	QUANTITY

PROJECT IDENTIFICATION

JB #: JB0001659213  
ADDRESS: 120 SILVERLEAF DR  
CITY, STATE, ZIP: MADISON, MS, 39110  
COUNTY: MADISON  
COORDINATOR: KENNETH GOSS  
DATE: 12-07-23  
REVISION: 0

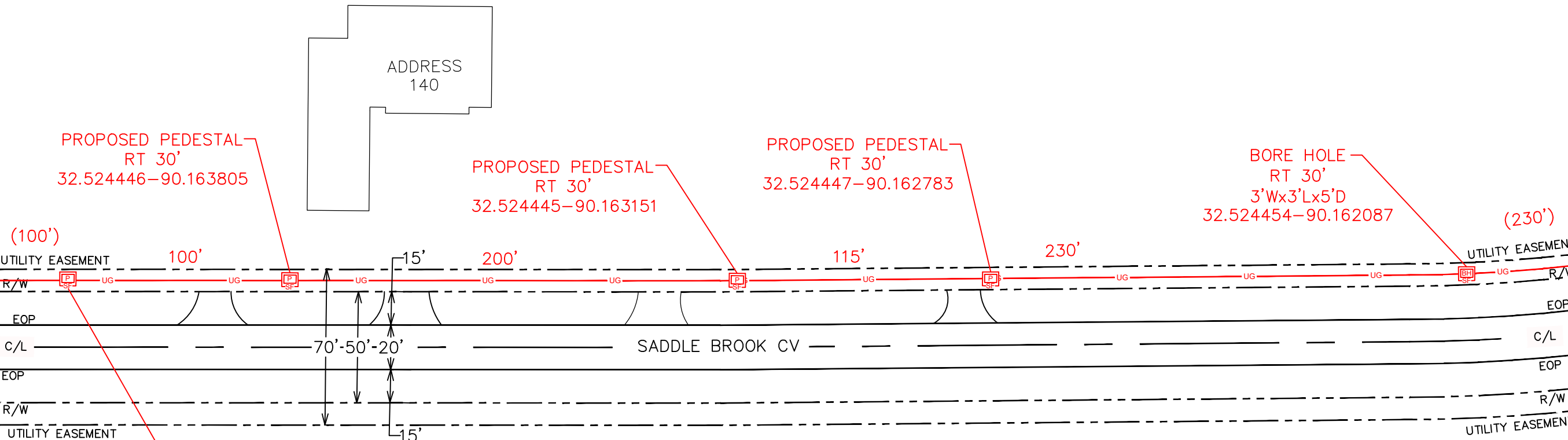

PROPOSED COMCAST UNDERGROUND  
DIRECTIONAL BORE  
ONE 2" HDPE CONDUIT  
5' MIN DEPTHS ALL POINTS

SHEET 13

SHEET 11



ENGINEERED FOR:



**DISCLAIMER**

THESE DRAWINGS AND SPECIFICATIONS BEING ISSUED IN STRICT CONFIDENCE AND SHALL NOT BE REPRODUCED, COPIED, OR USED FOR ANY PURPOSE WITHOUT SPECIFIC WRITTEN PERMISSION

**PROJECT TOTAL FOOTAGES**

NEW AERIAL BUILD	0'
NEW OVERLASH	0'
NEW BURIED	15790'



**MATERIAL LIST**

DESCRIPTION	QUANTITY

**PROJECT IDENTIFICATION**

JB #: JB0001659213  
 ADDRESS: 120 SILVERLEAF DR  
 CITY, STATE, ZIP: MADISON, MS, 39110  
 COUNTY: MADISON  
 COORDINATOR: KENNETH GOSS  
 DATE: 12-07-23  
 REVISION: 0

SHEET 14

SHEET 12

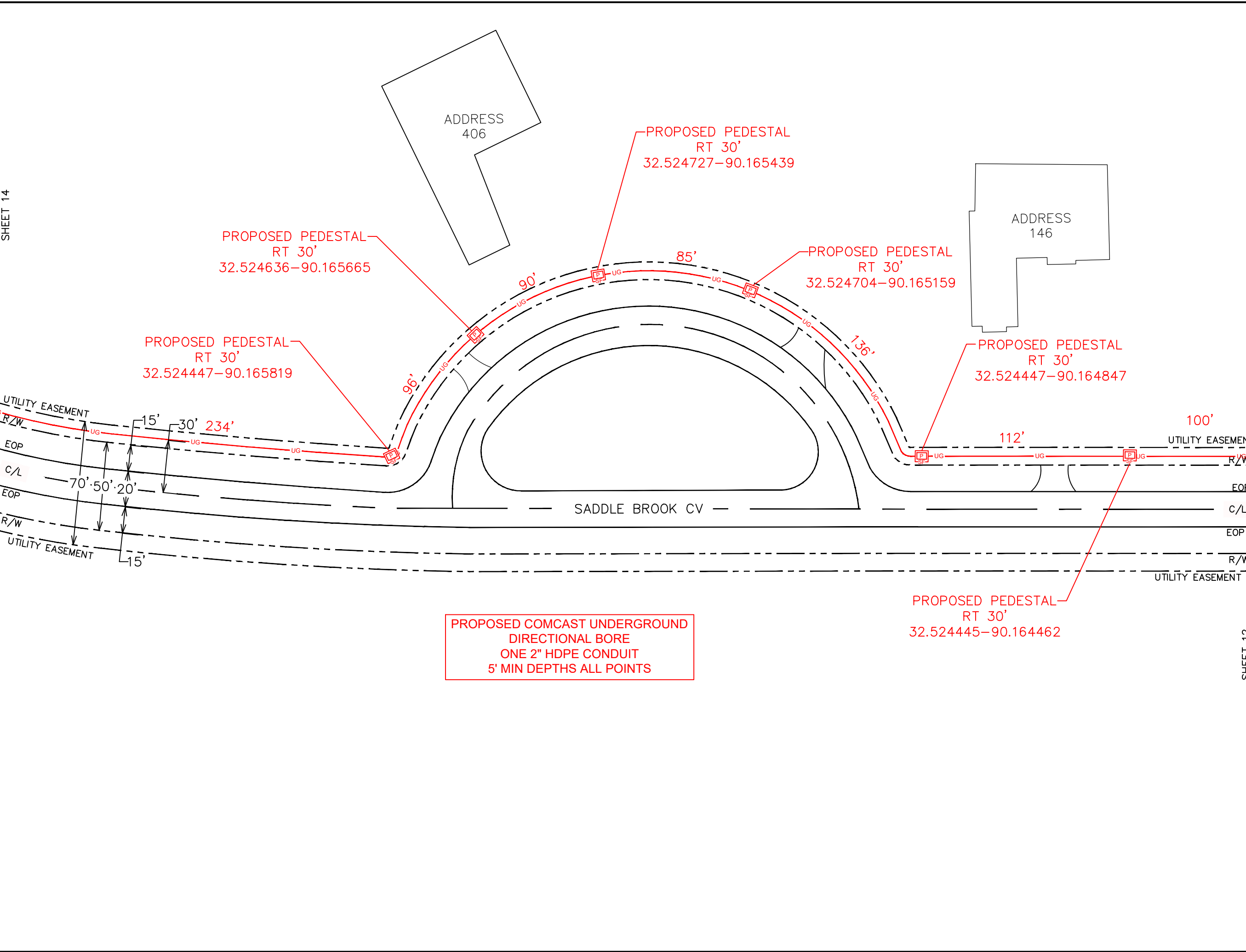

PROPOSED PEDESTAL  
RT 30'  
32.524636-90.165665

PROPOSED PEDESTAL  
RT 30'  
32.524727-90.165439

PROPOSED PEDESTAL  
RT 30'  
32.524704-90.165159

PROPOSED PEDESTAL  
RT 30'  
32.524447-90.165819

PROPOSED PEDESTAL  
RT 30'  
32.524447-90.164847

PROPOSED PEDESTAL  
RT 30'  
32.524445-90.164462

PROPOSED COMCAST UNDERGROUND  
DIRECTIONAL BORE  
ONE 2" HDPE CONDUIT  
5' MIN DEPTHS ALL POINTS

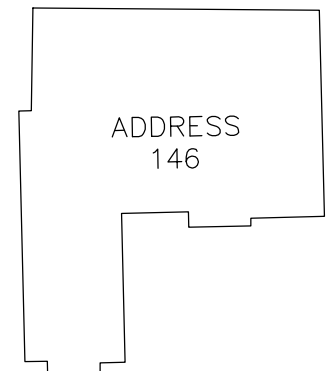

SADDLE BROOK CV

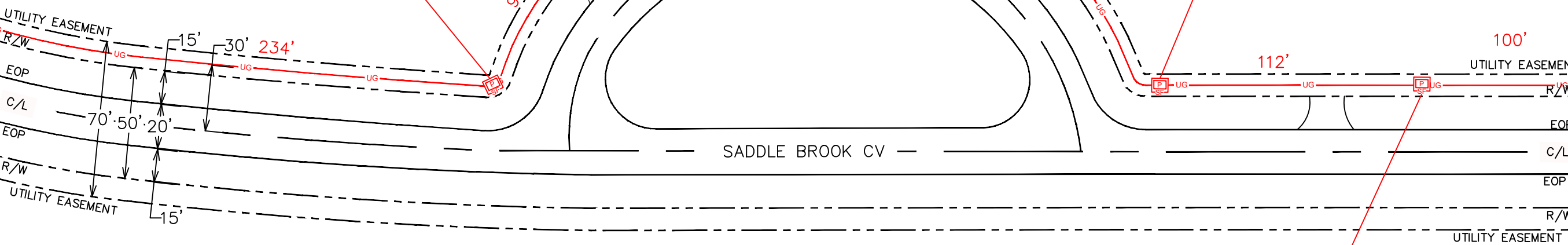

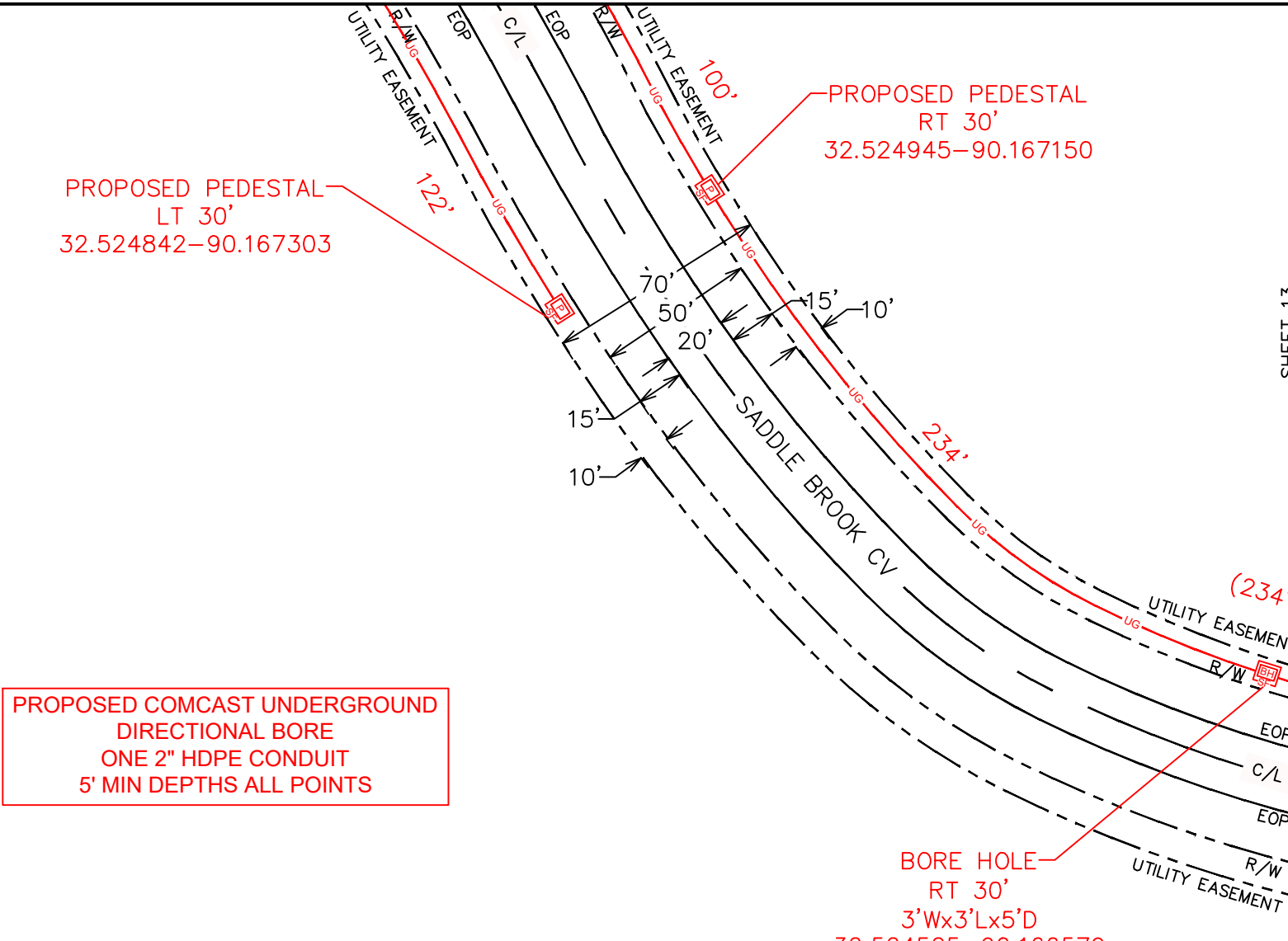

PROPOSED COMCAST UNDERGROUND  
DIRECTIONAL BORE  
ONE 2" HDPE CONDUIT  
5' MIN DEPTHS ALL POINTS

ENGINEERED BY:  
PERMITS@NWAUTILITIES.COM



ENGINEERED FOR:



DISCLAIMER

THESE DRAWINGS AND SPECIFICATIONS  
BEING ISSUED IN STRICT  
CONFIDENCE AND SHALL NOT BE  
REPRODUCED,  
COPIED, OR USED FOR ANY PURPOSE  
WITHOUT SPECIFIC WRITTEN PERMISSION

PROJECT TOTAL FOOTAGES

NEW AERIAL BUILD	0'
NEW OVERLASH	0'
NEW BURIED	15790'



MATERIAL LIST

DESCRIPTION	QUANTITY

PROJECT IDENTIFICATION

JB #: JB0001659213  
 ADDRESS: 120 SILVERLEAF DR  
 CITY, STATE, ZIP: MADISON, MS, 39110  
 COUNTY: MADISON  
 COORDINATOR: KENNETH GOSS  
 DATE: 12-07-23  
 REVISION: 0

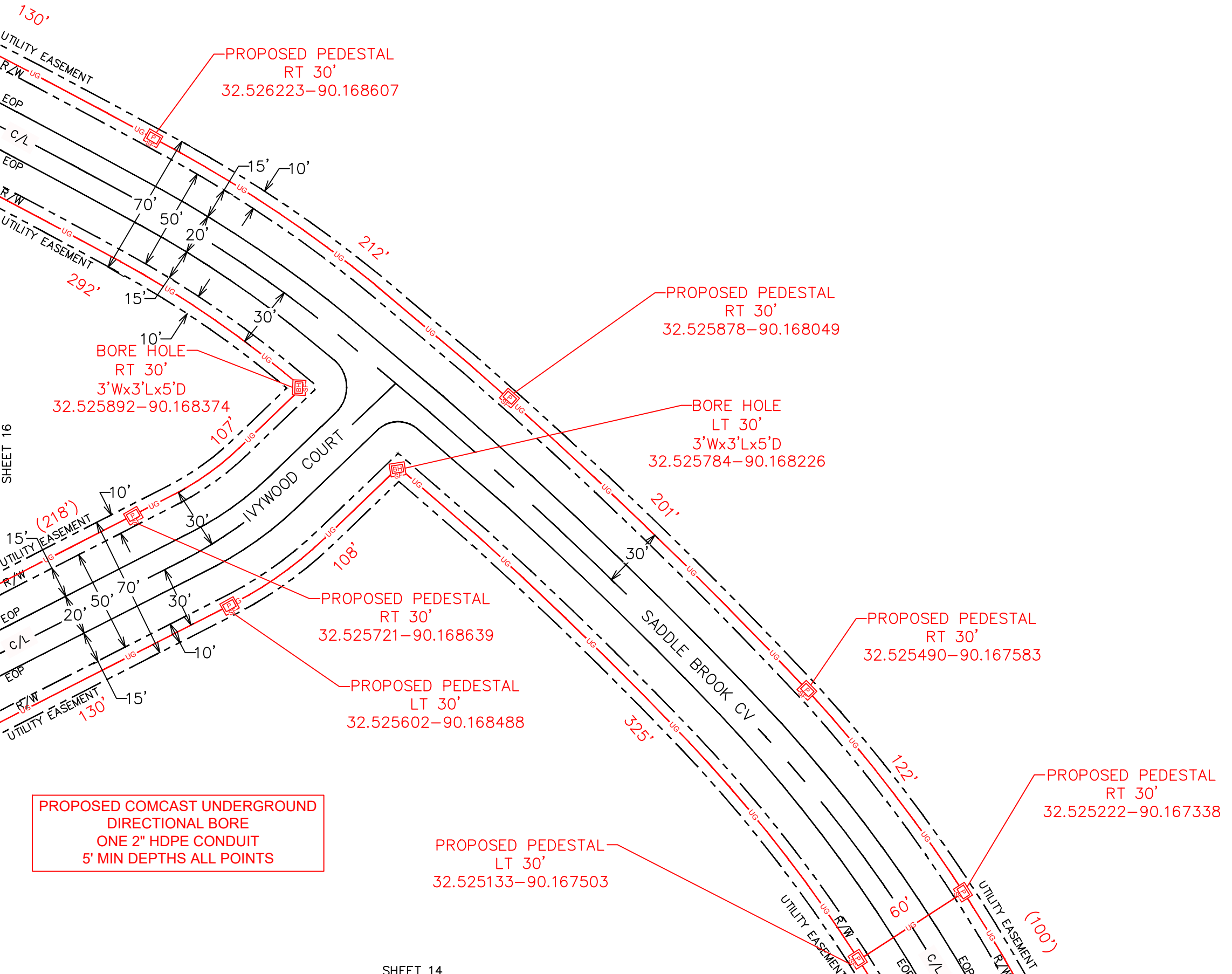

ENGINEERED FOR:

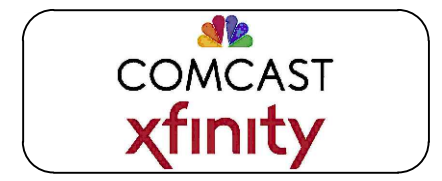

**DISCLAIMER**

THESE DRAWINGS AND SPECIFICATIONS BEING ISSUED IN STRICT CONFIDENCE AND SHALL NOT BE REPRODUCED, COPIED, OR USED FOR ANY PURPOSE WITHOUT SPECIFIC WRITTEN PERMISSION

**PROJECT TOTAL FOOTAGES**

NEW AERIAL BUILD	0'
NEW OVERLASH	0'
NEW BURIED	15790'



**MATERIAL LIST**

DESCRIPTION	QUANTITY

**PROJECT IDENTIFICATION**

JB #: JB0001659213
ADDRESS: 120 SILVERLEAF DR
CITY, STATE, ZIP: MADISON, MS, 39110
COUNTY: MADISON
COORDINATOR: KENNETH GOSS
DATE: 12-07-23
REVISION: 0





SHEET 15

ENGINEERED FOR:



**DISCLAIMER**

THESE DRAWINGS AND SPECIFICATIONS BEING ISSUED IN STRICT CONFIDENCE AND SHALL NOT BE REPRODUCED, COPIED, OR USED FOR ANY PURPOSE WITHOUT SPECIFIC WRITTEN PERMISSION

**PROJECT TOTAL FOOTAGES**

NEW AERIAL BUILD	0'
NEW OVERLASH	0'
NEW BURIED	15790'



**MATERIAL LIST**

DESCRIPTION	QUANTITY

**PROJECT IDENTIFICATION**

JB #: JB0001659213
ADDRESS: 120 SILVERLEAF DR
CITY, STATE, ZIP: MADISON, MS, 39110
COUNTY: MADISON
COORDINATOR: KENNETH GOSS
DATE: 12-07-23
REVISION: 0

PROPOSED COMCAST UNDERGROUND DIRECTIONAL BORE  
ONE 2" HDPE CONDUIT  
5' MIN DEPTHS ALL POINTS

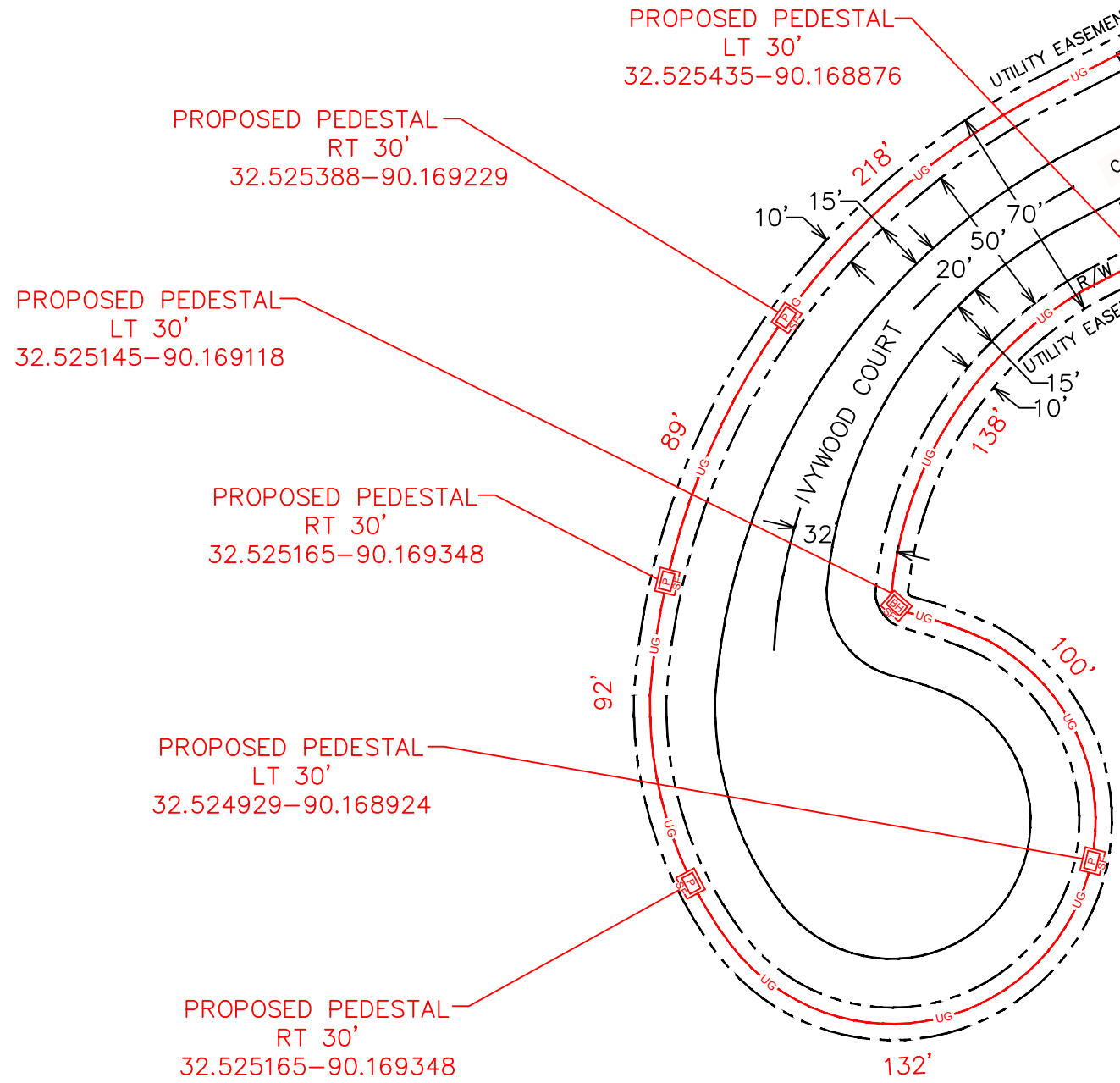



PROPOSED PEDESTAL  
LT 30'  
32.527285-90.170525

PROPOSED PEDESTAL  
RT 30'  
32.527024-90.170124

PROPOSED PEDESTAL  
LT 30'  
32.526927-90.170282

PROPOSED PEDESTAL  
LT 30'  
32.526704-90.170012

PROPOSED PEDESTAL  
RT 30'  
32.526671-90.169623

PROPOSED PEDESTAL  
RT 30'  
32.526391-90.168984

PROPOSED COMCAST UNDERGROUND  
DIRECTIONAL BORE  
ONE 2" HDPE CONDUIT  
5' MIN DEPTHS ALL POINTS

BORE HOLE  
LT 30'  
3'Wx3'Lx5'D  
32.526295-90.169188

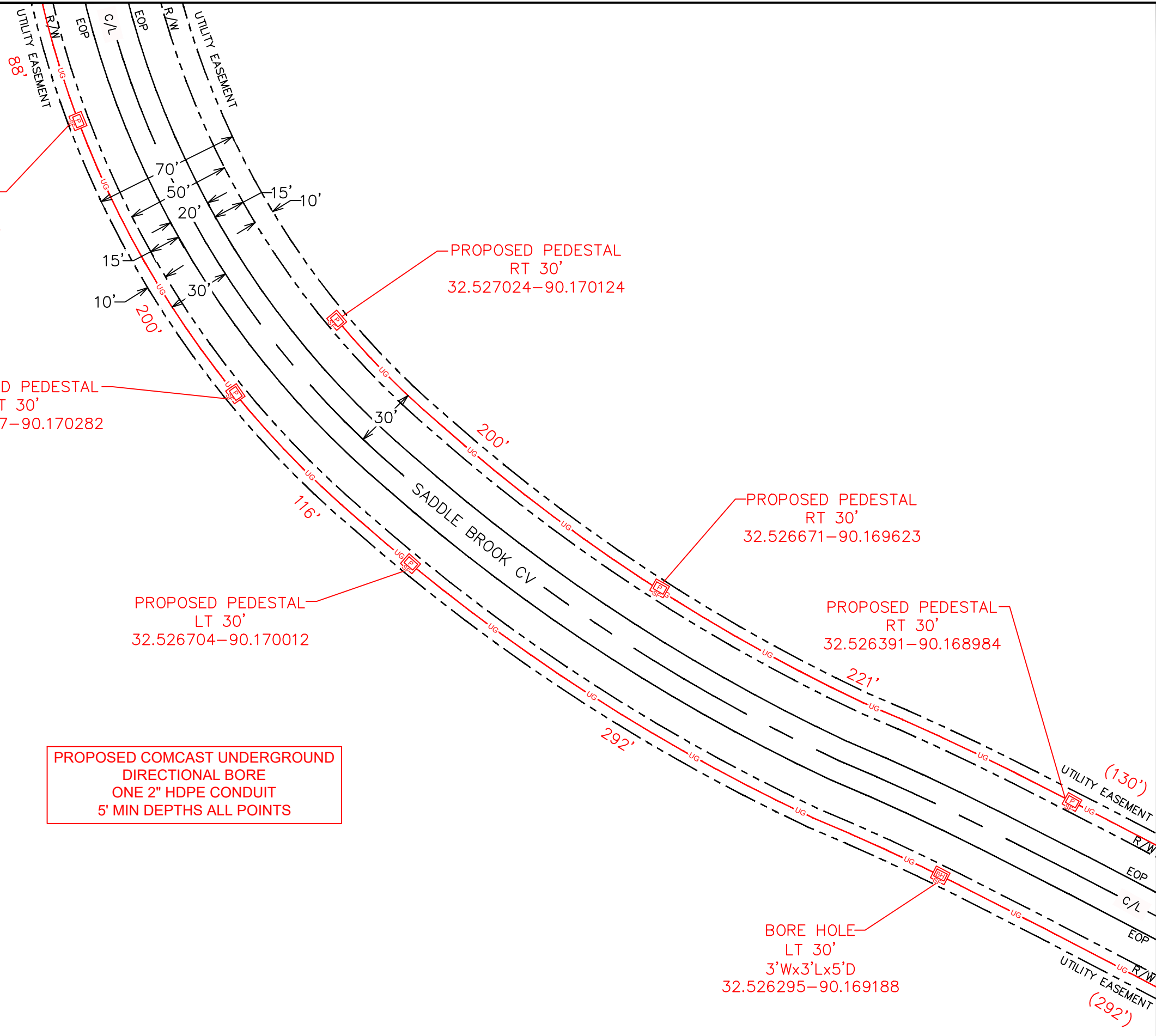

ENGINEERED BY:  
PERMITS@NWAUTILITIES.COM

**NWA COMMUNICATIONS**

ENGINEERED FOR:

**COMCAST xfinity**

**811** Know what's below.  
811 before you dig.

DISCLAIMER  
THESE DRAWINGS AND SPECIFICATIONS  
BEING ISSUED IN STRICT  
CONFIDENCE AND SHALL NOT BE  
REPRODUCED,  
COPIED, OR USED FOR ANY PURPOSE  
WITHOUT SPECIFIC WRITTEN PERMISSION

PROJECT TOTAL FOOTAGES

NEW AERIAL BUILD	0'
NEW OVERLASH	0'
NEW BURIED	15790'



MATERIAL LIST

DESCRIPTION	QUANTITY

PROJECT IDENTIFICATION

JB #: JB0001659213  
ADDRESS: 120 SILVERLEAF DR  
CITY, STATE, ZIP: MADISON, MS, 39110  
COUNTY: MADISON  
COORDINATOR: KENNETH GOSS  
DATE: 12-07-23  
REVISION: 0

SHEET 15

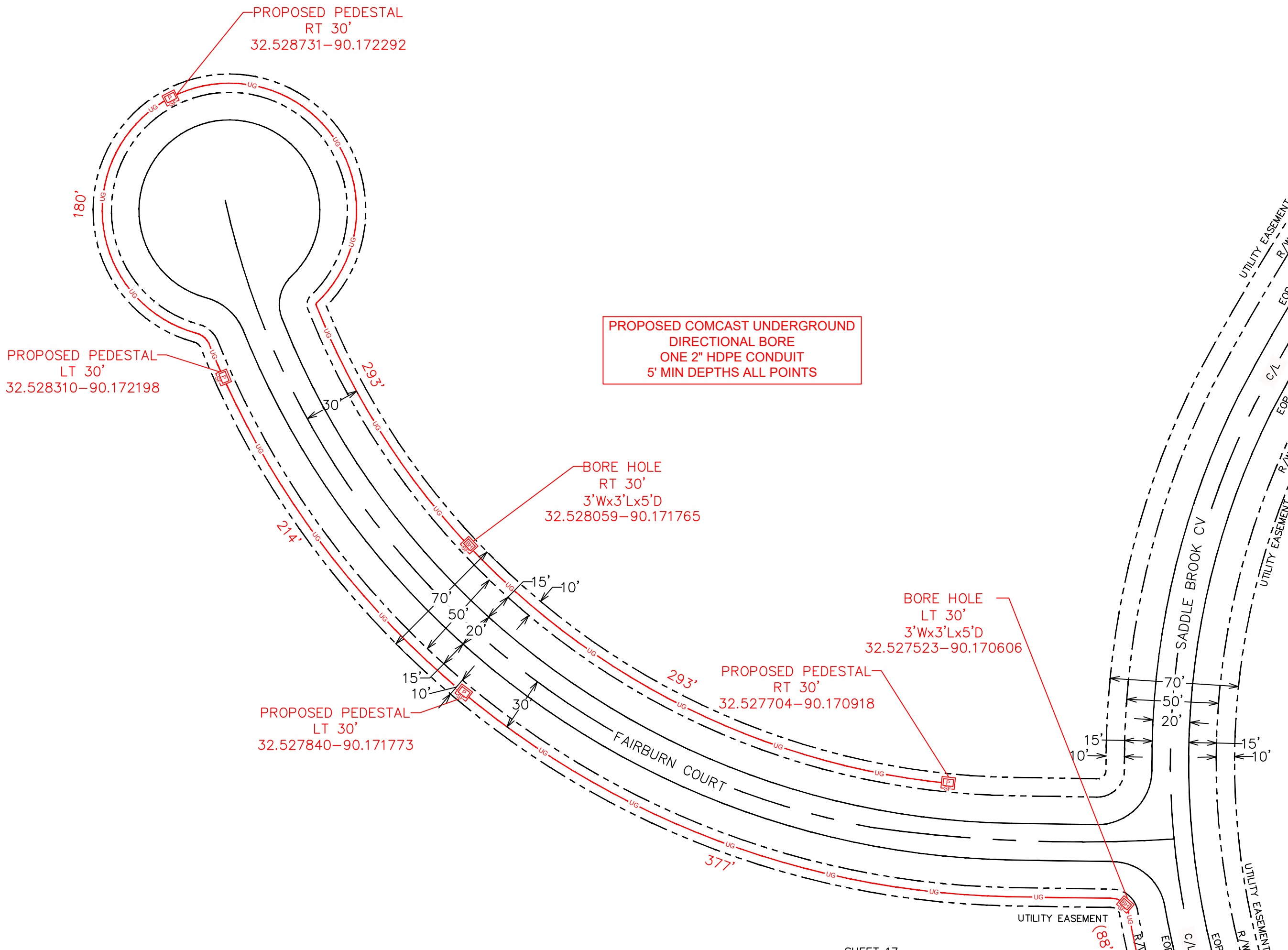

DISCLAIMER  
THESE DRAWINGS AND SPECIFICATIONS BEING ISSUED IN STRICT CONFIDENCE AND SHALL NOT BE REPRODUCED, COPIED, OR USED FOR ANY PURPOSE WITHOUT SPECIFIC WRITTEN PERMISSION

PROJECT TOTAL FOOTAGES

NEW AERIAL BUILD	0'
NEW OVERLASH	0'
NEW BURIED	15790'



MATERIAL LIST

DESCRIPTION	QUANTITY

PROJECT IDENTIFICATION

JB #: JB0001659213  
ADDRESS: 120 SILVERLEAF DR  
CITY, STATE, ZIP: MADISON, MS, 39110  
COUNTY: MADISON  
COORDINATOR: KENNETH GOSS  
DATE: 12-07-23  
REVISION: 0

ENGINEERED BY:  
PERMITS@NWAUTILITIES.COM



ENGINEERED FOR:



DISCLAIMER

THESE DRAWINGS AND SPECIFICATIONS  
BEING ISSUED IN STRICT  
CONFIDENCE AND SHALL NOT BE  
REPRODUCED,  
COPIED, OR USED FOR ANY PURPOSE  
WITHOUT SPECIFIC WRITTEN PERMISSION

PROJECT TOTAL FOOTAGES

NEW AERIAL BUILD	0'
NEW OVERLASH	0'
NEW BURIED	15790'



MATERIAL LIST

DESCRIPTION	QUANTITY

PROJECT IDENTIFICATION

JB #: JB0001659213  
ADDRESS: 120 SILVERLEAF DR  
CITY, STATE, ZIP: MADISON, MS, 39110  
COUNTY: MADISON  
COORDINATOR: KENNETH GOSS  
DATE: 12-07-23  
REVISION: 0

STATE HWY  
TYPICAL AERIAL  
HEIGHT

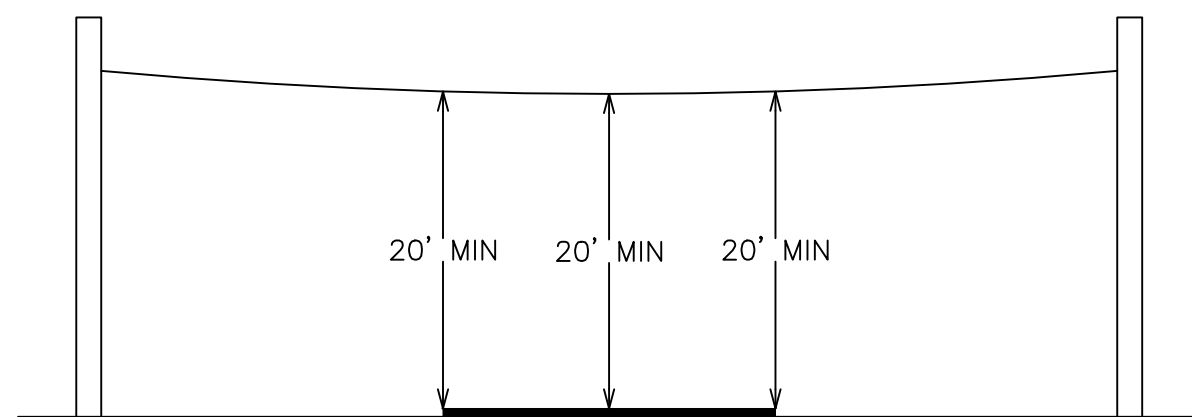

INTERSTATE  
TYPICAL AERIAL  
HEIGHT

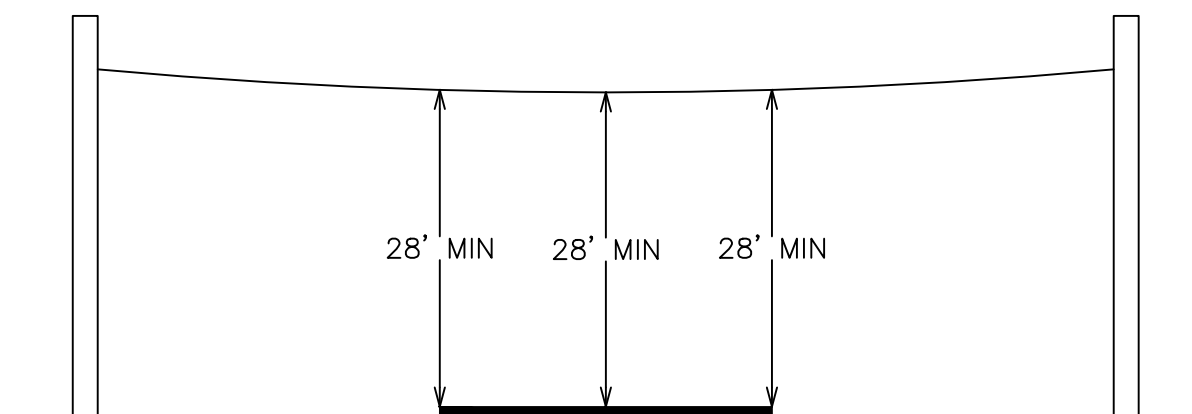

TYPICAL UNDERGROUND  
DEPTH

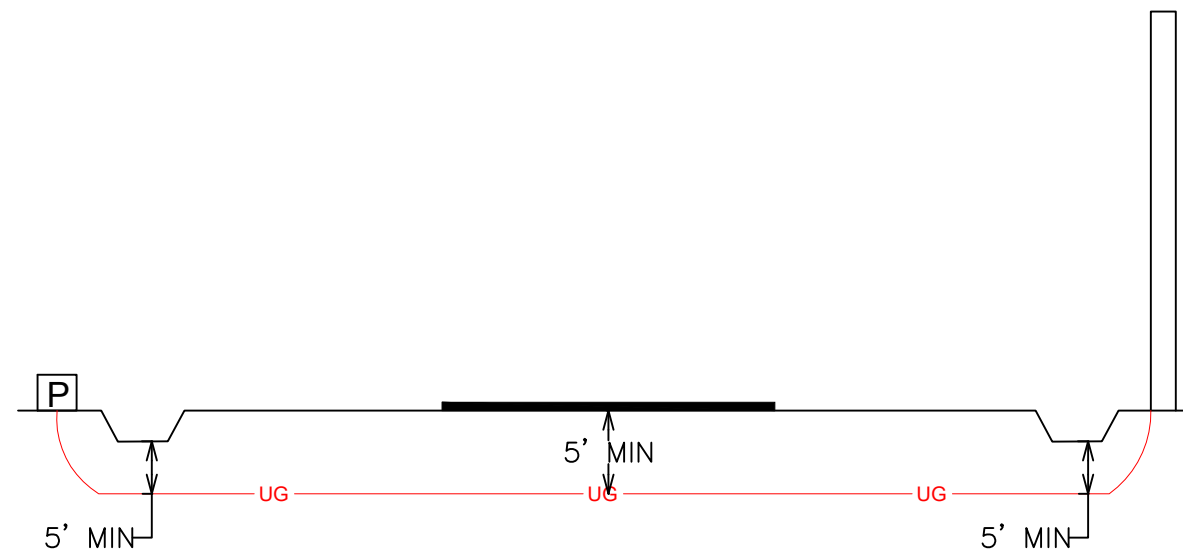



ENGINEERED FOR:



**DISCLAIMER**

THESE DRAWINGS AND SPECIFICATIONS  
BEING ISSUED IN STRICT  
CONFIDENCE AND SHALL NOT BE  
REPRODUCED,  
COPIED, OR USED FOR ANY PURPOSE  
WITHOUT SPECIFIC WRITTEN PERMISSION

**PROJECT TOTAL FOOTAGES**

NEW AERIAL BUILD	0'
NEW OVERLASH	0'
NEW BURIED	15790'



**MATERIAL LIST**

DESCRIPTION	QUANTITY

**PROJECT IDENTIFICATION**

JB #: JB0001659213  
 ADDRESS: 120 SILVERLEAF DR  
 CITY, STATE, ZIP: MADISON, MS, 39110  
 COUNTY: MADISON  
 COORDINATOR: KENNETH GOSS  
 DATE: 12-07-23  
 REVISION: 0

